

A decorative graphic on the left side of the page features several green circles of varying sizes and four detailed images of green leaves with prominent veins. The leaves are arranged in a cluster, with one large leaf at the top right and three smaller ones below it. The circles are scattered around the leaves, with one large circle at the top left and two smaller ones at the bottom left.

Detail Drawing Dictionary

Angelica Moshri
Mary Villanueva
Corinne Klein
Farheen Hyder

Berm

A Berm is generally a level space, shelf, or raised barrier (usually made of compacted soil) separating two areas. It can be seen as any stretch of grass or land that forms a kind of shelf above or along a river, train tracks, or highway. Some berms are a natural feature of the landscape, while others are man made.

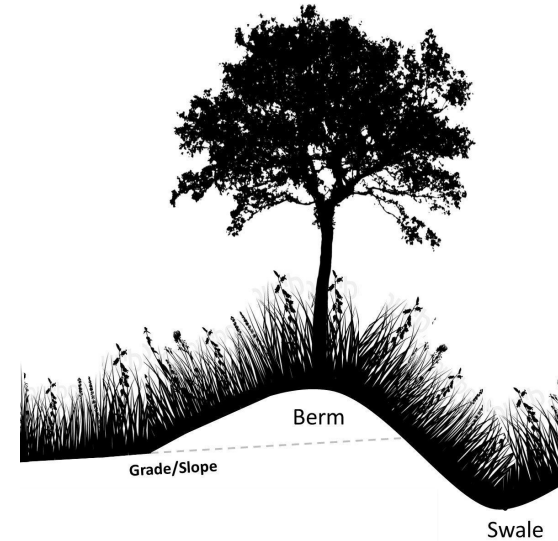
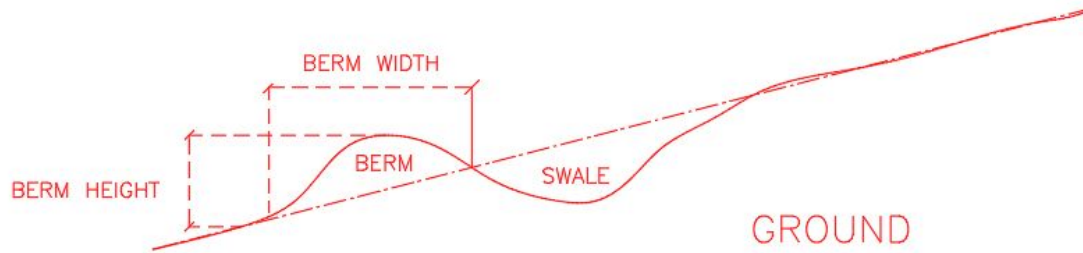

Deciduous Tree

Deciduous trees are giant flowering plants. They include oaks, maples, and beeches, and they grow in many parts of the world. The word **deciduous** means to “fall off,” and every fall these **trees** shed their leaves. Most **deciduous trees** are broad-leaved, with wide, flat leaves.



Drip line from tree

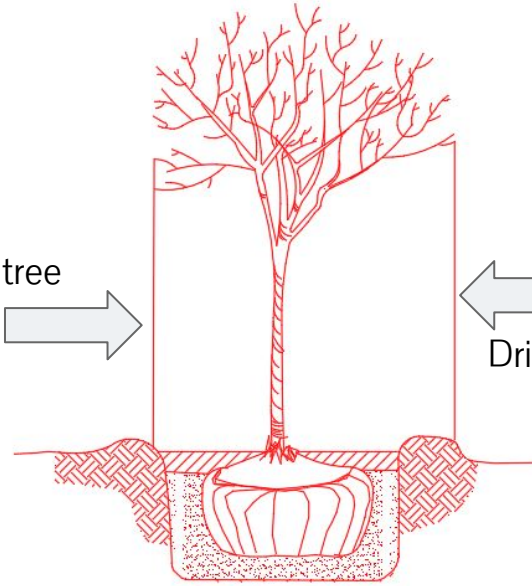

Drip line from tree

Plan view

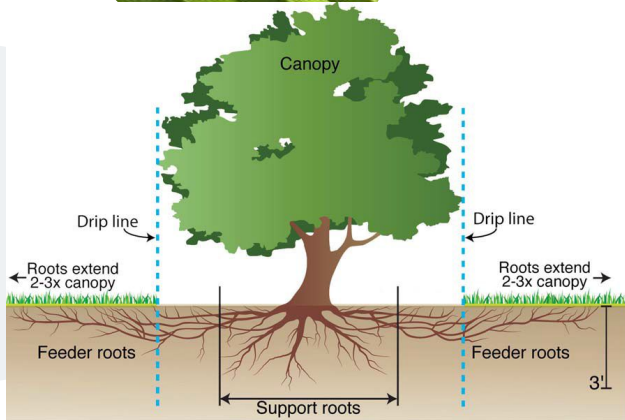

<https://californiareleaf.org/saveoutrees/faqs/>

Buffer

Most commonly used by local governments and land developers, a buffer (buffer zoning) is a technique to create a neutral space between two different types of buildings or properties with an interest of minimizing disturbances between potentially incompatible land uses.

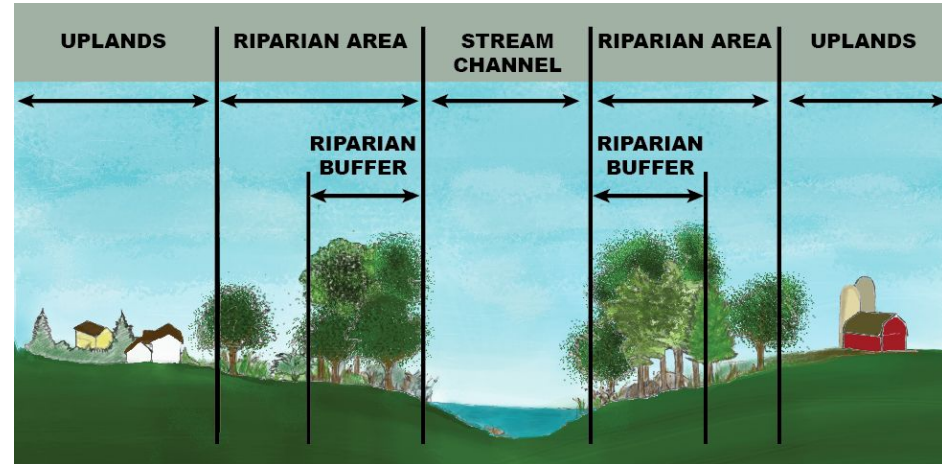
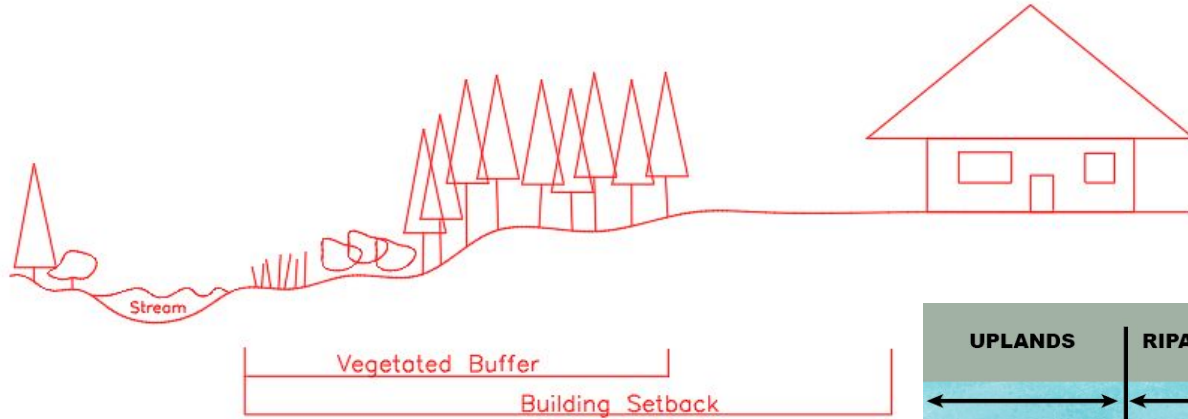

https://real-estate-law.freeadvice.com/real-estate-law/zoning/buffer_zoning.htm

Bulb-out



Bulb-out (Curb extensions): extend the sidewalk into the parking lane to narrow the roadway and provide additional pedestrian space at key locations; they can be used at corners and at mid-block.

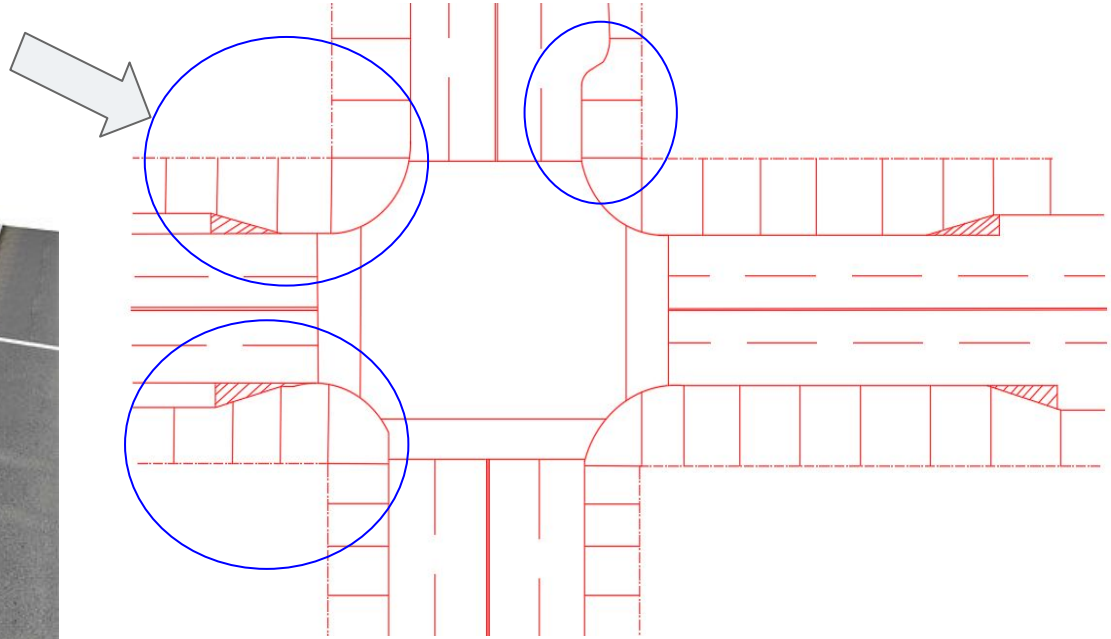

<https://ggwash.org/view/40519/bulb-outs-could-make-crossing-the-street-safer-at-key-trouble-spots>

Reinforced Concrete Retaining Wall

<https://theconstructor.org/structures/types-of-reinforced-concrete-retaining-wall/8393/>

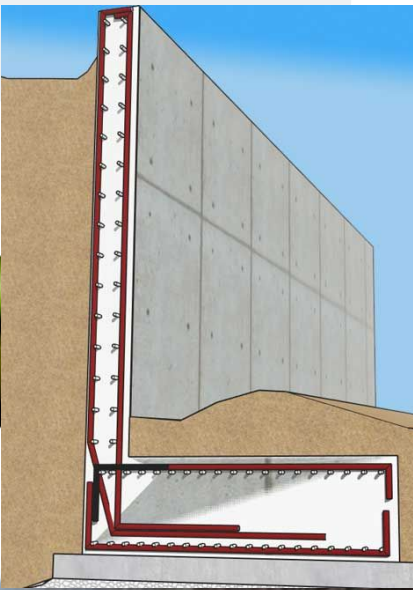

A Retaining wall is a structure that retains (holds back) any material (usually earth) and prevents it from sliding or eroding away. It is designed so that to resist the material pressure of the material that it is holding back.

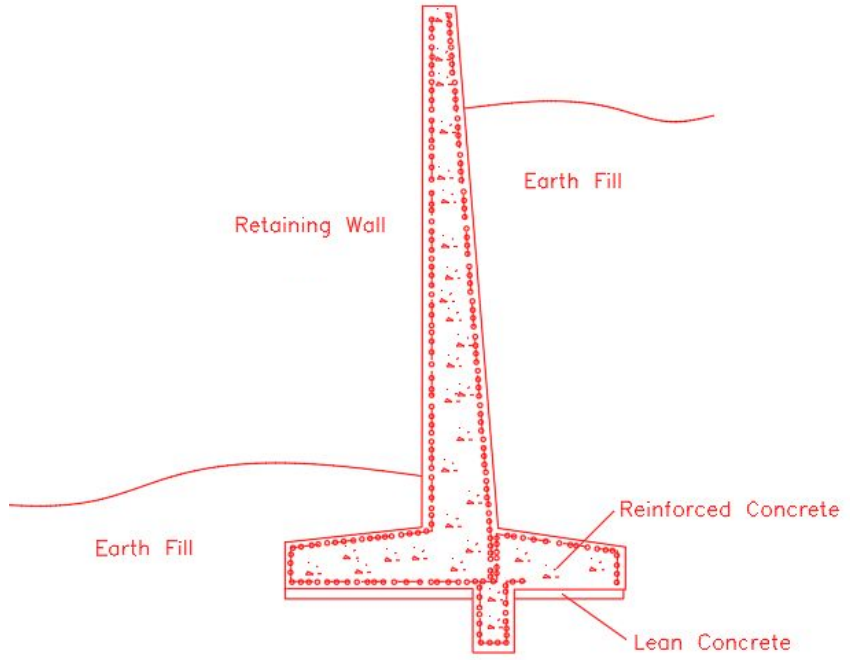

Catch Basin

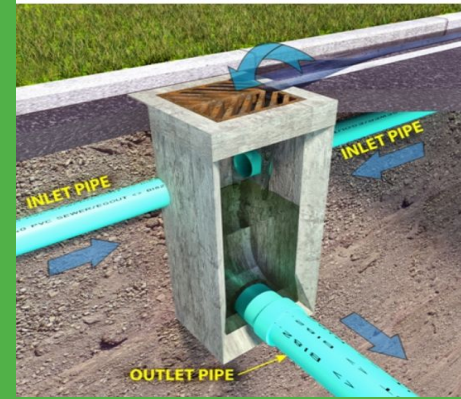

A Catch Basin is a drainage collection basin designed to catch drainage water runoff, with a grate or screen, designed to prevent obstructive material from entering and blocking the drainage lines.

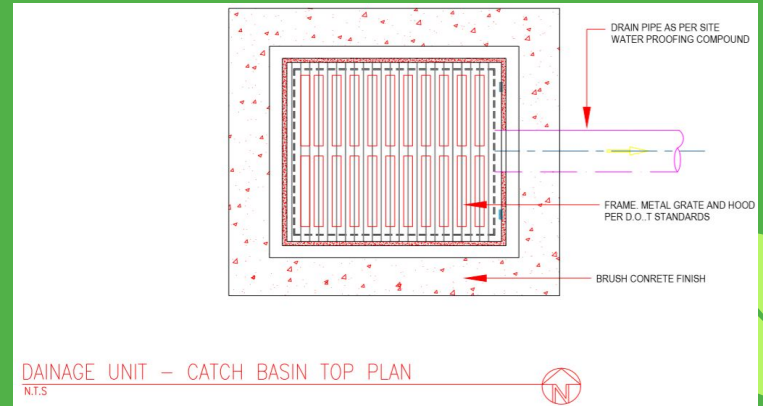
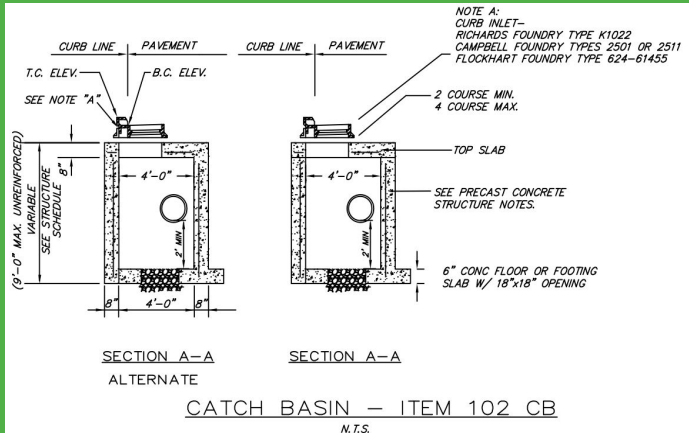
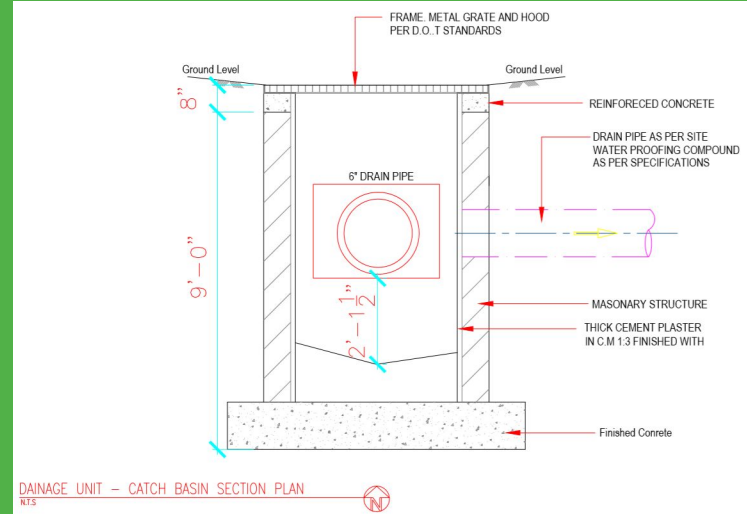

Culvert

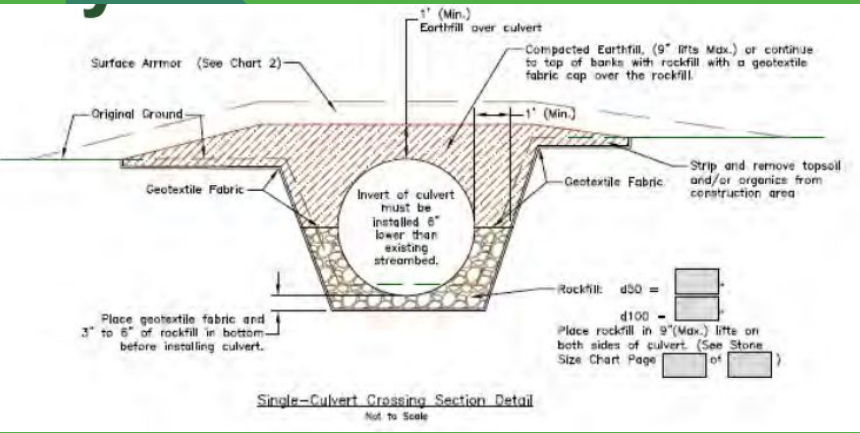

A culvert is a structure that allows water to flow under a road, railroad, trail, or similar obstruction from one side to the other side. Typically embedded and surrounded by soil, a culvert may be made from a pipe, reinforced concrete or other material.

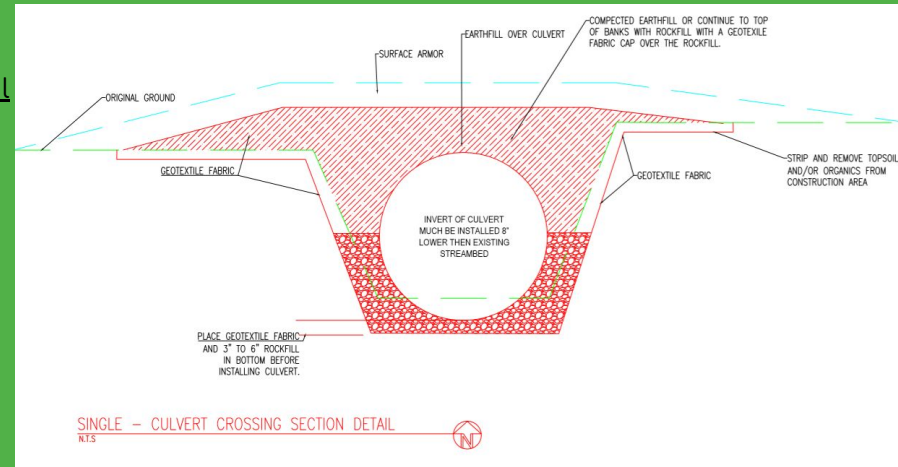

<https://www.dcr.virginia.gov/soil-and-water/document/des-str-m-xing-culverts.pdf>

Sight Triangle

A sight triangle provides an adequate sight distance for a stopped driver on a minor roadway to depart from the intersection and enter or cross the major roadway. This sight triangle should be provided in each quadrant of a controlled intersection.

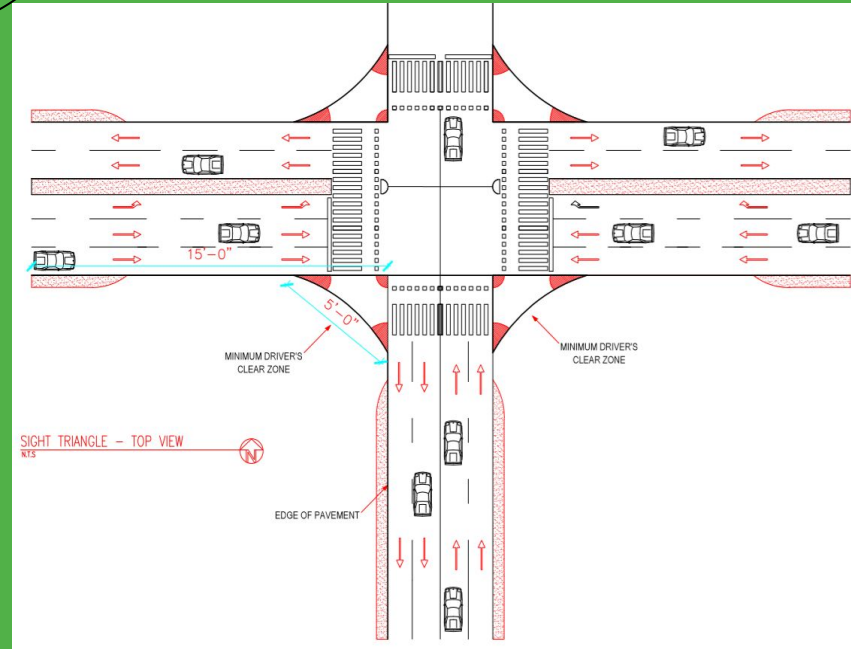
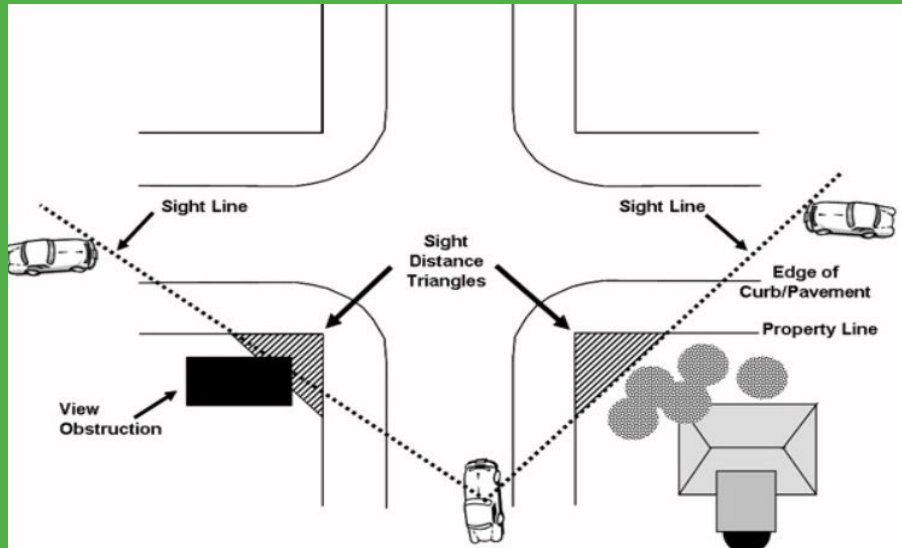

<http://online.encodeplus.com/reg/siouxcity/doc-view.aspx?pn=0&ajax=0&secid=562>
<https://www.villageofparkforest.com/DocumentCenter/View/3226/Driveway-Permit->

Concrete Accessible Ramp

A wheelchair ramp is an inclined plane installed in addition to or instead of stairs. Ramps permit wheelchair users, as well as people pushing strollers, carts, or other wheeled objects, to easily access a building. A wheelchair ramp can be permanent, semi-permanent or portable.

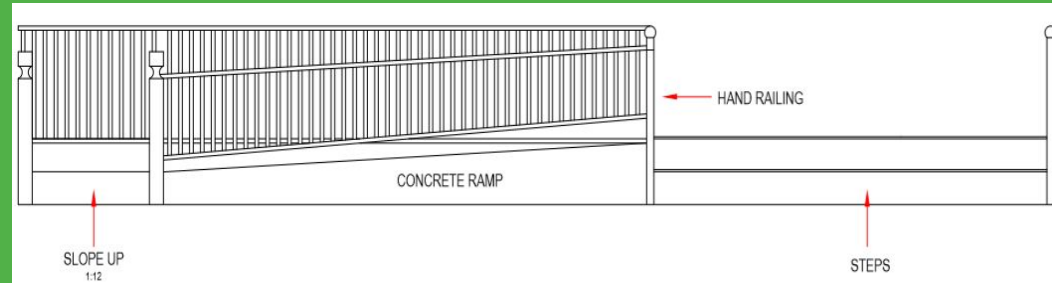
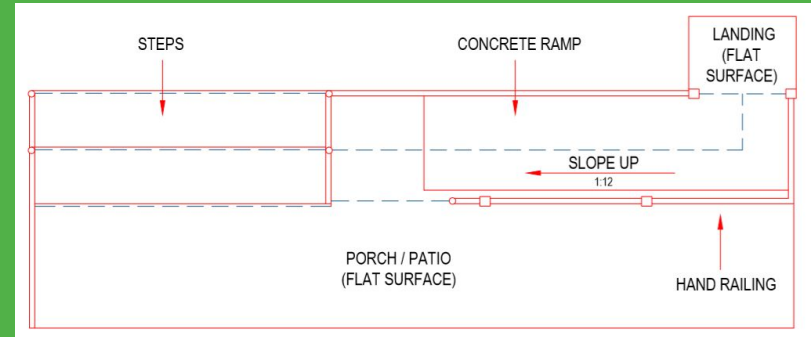

Typical Planned Parking Lot Island

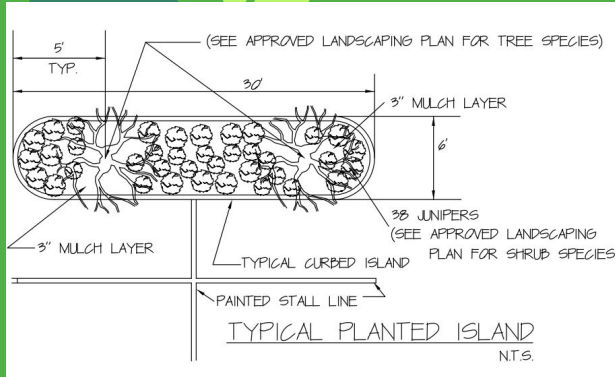

Parking lot islands provide shade canopy and to break up the visual monotony of large asphalt covered areas. The landscaped terminal islands should be at the end of each parking row and should contain at least two trees. The landscaped island is approximately the size of two parking spaces.

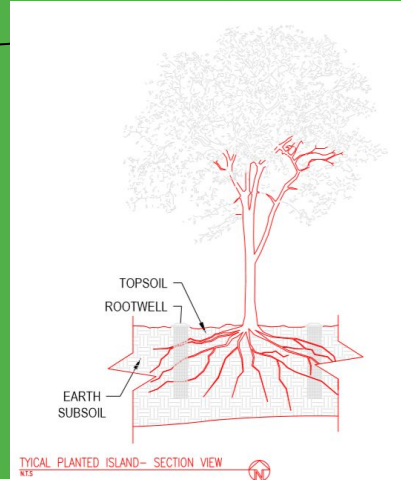

<https://islipny.gov/community-and-services/documents/planning-development/engineering/789-subdivision-and-land-development-regulations-appendix-c-construction-standards/file>



Farmingdale State college

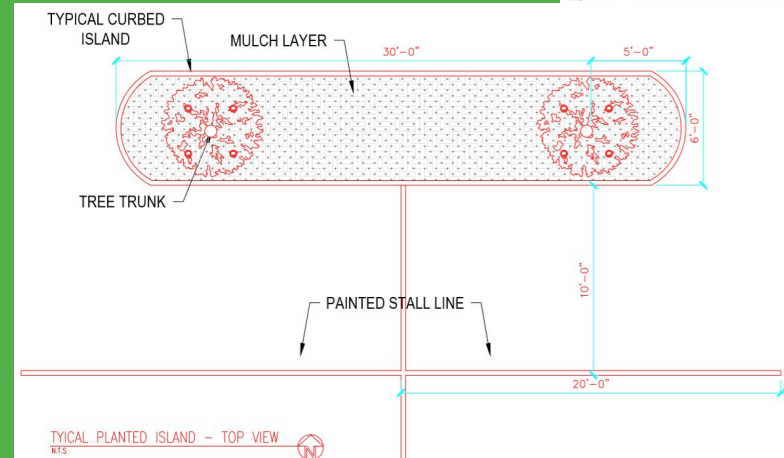

Septic Tank

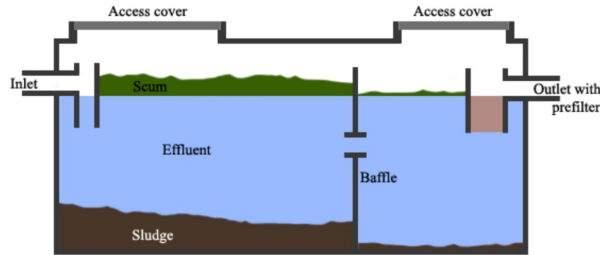
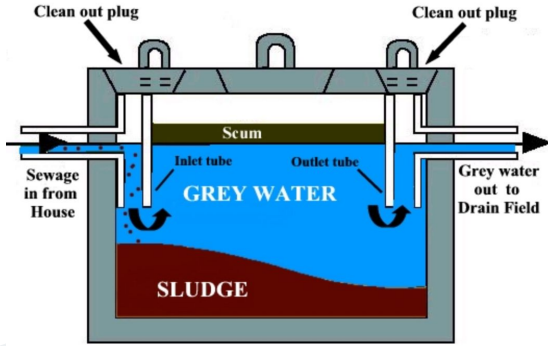

A septic tank is a water-tight box made of concrete blocks, precast concrete, or reinforced fiberglass placed underground. When sewage from the house flows to the septic tank, the sludge settle on the bottom of the tank while the scum floats and grey water flows out to the drain field. When the septic tank overflows, waste water will flow to the leaching pool.

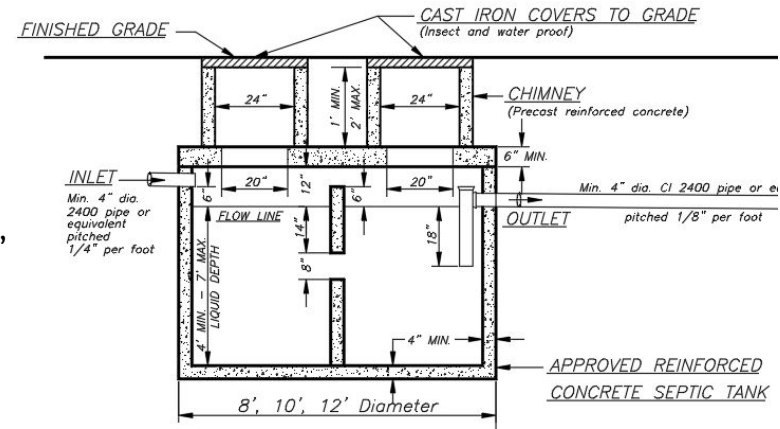

SEPTIC TANK DETAILS
Not to Scale

Details from AutoCAD provided by Prof. Lopiccolo



<https://www.indiamart.com/kisan-cementpipe-industries/sewage-tank.html>
<https://abccesspoolandsepticpumping.com/septic-tank-cesspool/>

Leaching Pool

Leaching Pools or dry wells are pits made of concrete, brick or cement block placed underground. Waste water flows from the septic tank and as it overflows, water goes to the leaching pool, in which the water drains into the soil through the perforated walls. Certain setbacks between the house, septic tank, leaching pool and property line, as well as the depth of the well are required depending on the municipality.

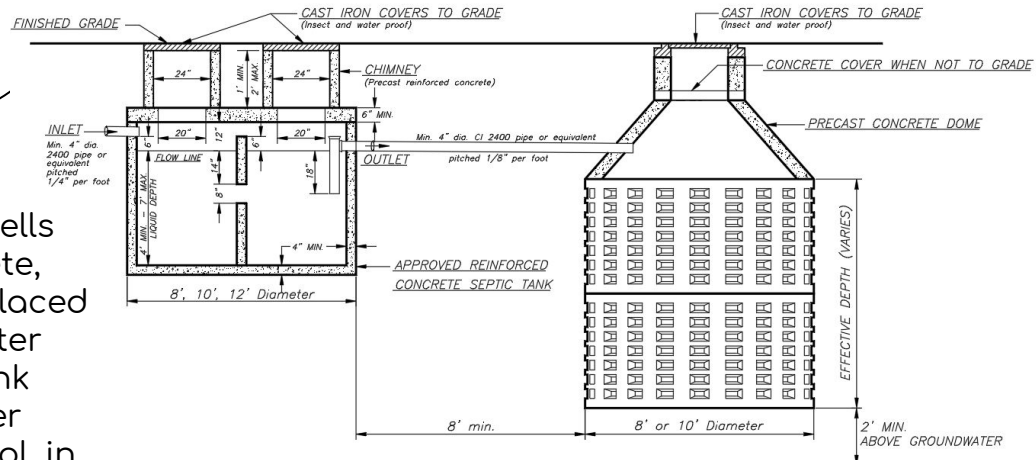

SEPTIC TANK TO LEACHING POOL DETAILS

Not to Scale

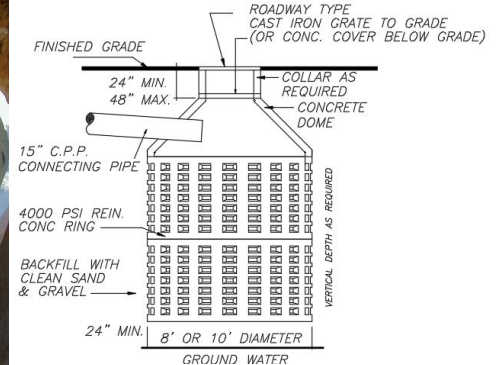

LEACHING POOL DETAILS

Not to Scale

Details from AutoCAD provided by Prof. Lopiccolo

Trench Drain



Trench drains are surface drainage structure with a grate on top installed to rapidly move water, usually rainwater, to a catch basin. Trench drains are embedded in the ground and are usually made of concrete. There are different types of trench drains: cast in place, former systems trench drains, precast concrete trench drains, and linear systems trench drains.

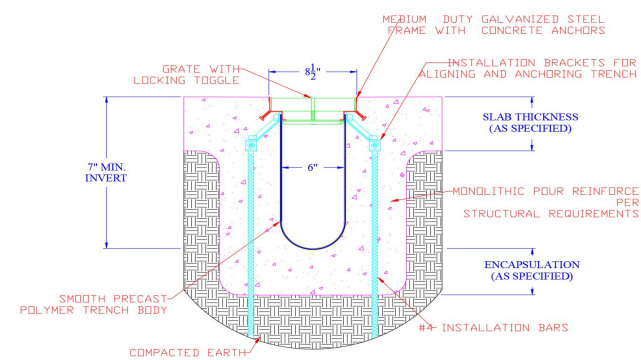

NOTES:

1. STANDARD SLOPE IS 0.5% UNLESS OTHERWISE SPECIFIED
2. REINFORCE ACCORDING TO STRUCTURAL REQUIREMENTS
3. TRENCH DRAIN MUST BE $\frac{1}{4}$ " BELOW FINISHED CONCRETE GRADE

TYPICAL DTPF6-MDGS15ZSA TRENCH SECTION

TRENCH DRAIN SECTION

Not to Scale

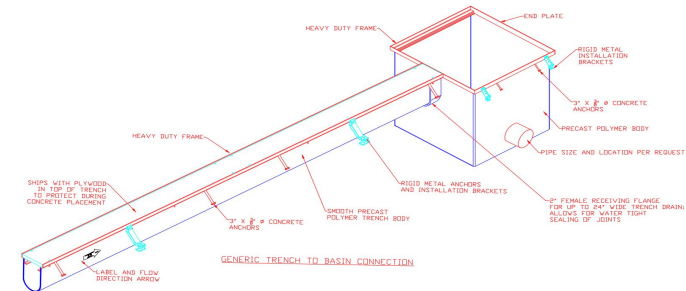

TRENCH DRAIN TO BASIN

Not to Scale

<https://www.duratrench.com/drawings>
<http://www.dumooresystems.com/p-61-Types-of-Trench-Drains>

Invert (of a pipe)



Invert of a pipe is the lowest point of the inside of a pipe. It has a minimum slope of 1/8th inch per foot, which the slope is necessary to facilitate the flow of sewer by gravity. The invert level of the pipe can be measured by knowing the elevation of the floor slab and ceiling height, which also helps to determine the location of a drop manhole if necessary.

<https://www.trenchlesspedia.com/definition/2852/invert-level>
<https://www.humes.co.nz/pipes/roller-compacted-pipe-rcp/>

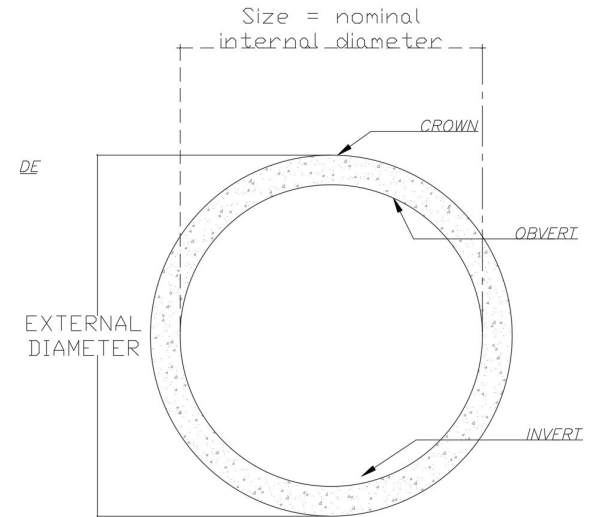

INVERT (of a Pipe)
Not to Scale

Mountable/Rolled Curb



Mountable or Rolled Curbs are curbs with sloping faces that allows vehicles to encroach the curb without damaging the tires. The low portions of the curb is called depressed curbs. Vehicles can cross the mountable/rolled curbs to access driveways.

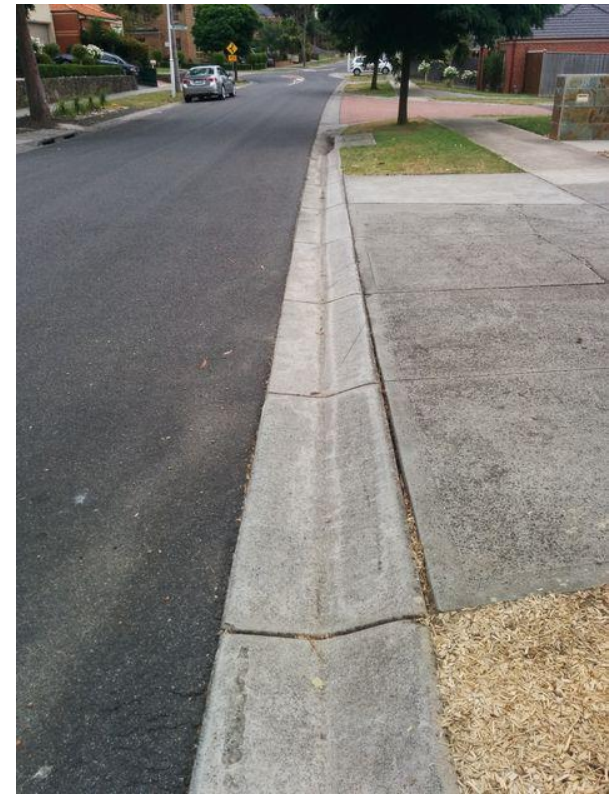

https://www.concreteparking.org/curbs/type_s.html

<https://www.pinterest.com/pin/563864815825683111>

https://www.chesco.org/DocumentCenter/View/27020/RoadwayDesignStds_DE?bidId=

Permeable Pavers

Permeable paving is a method used for paving pedestrian and vehicle pathways to allow the infiltration of stormwater runoff. The surfaces for the pavement includes asphalt, paving stones, concrete and interlocking pavers

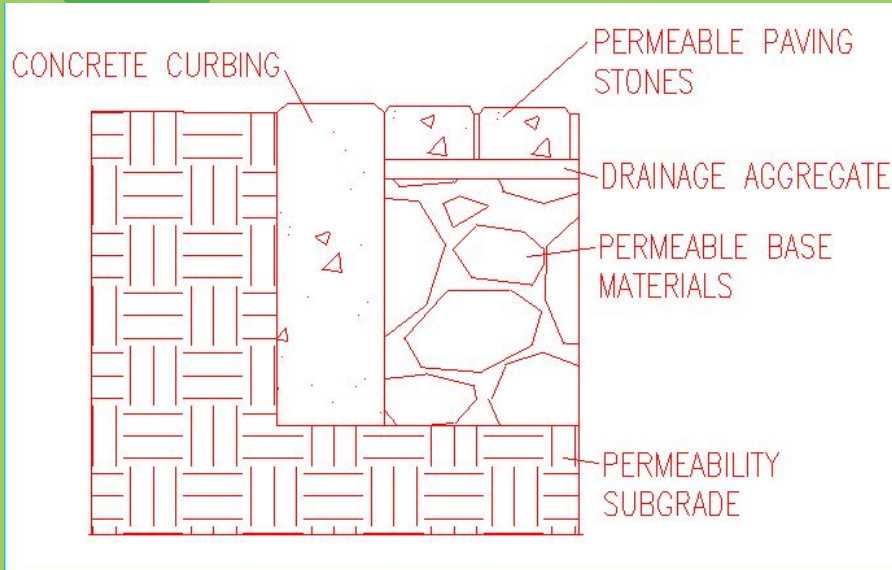

https://www.google.com/search?q=what+are+permeable+pavers&client=firefox-b-1-d&sxsrf=ACYBGNRtg_Emko0pkjlmRn0MyxAGbCkVxw:1571438549971&source=lnms&tbm=isch&sa=X&ved=0ahUKEwjIh7rk8KblAhWBTt8KHff1A_QQ_AUIEigC&biw=1525&bih=730#imgrc=wlbJFWgvPdtZM:

Concrete Pavers on Concrete Base for Pedestrians and Vehicles

Concrete Pavers (or known as paving stones) is an outdoor flooring option. The pavers are made in a factory in different shapes, colors and sizes. They arrive on site and ready to be installed

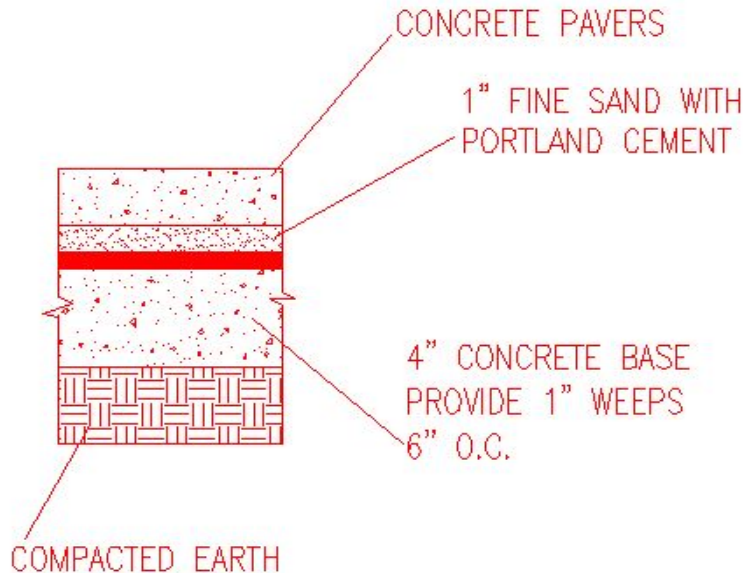

https://www.google.com/search?q=what+are+concrete+pavers&client=firefox-b-1-d&sxsrf=ACYBGNQNkvFqNdSkI_fU3Z0dxB6xEYVAcw:1571439997411&source=lnms&tbm=isch&sa=X&ved=0ahUKEwifjNOW9qbIAhVhmeAKHVE6CVoQ_AUIEigC&biw=1525&bih=730#imgrc=eU75ixrFoM47zM:

Concrete Sidewalk

Concrete is a common material used for sidewalks.

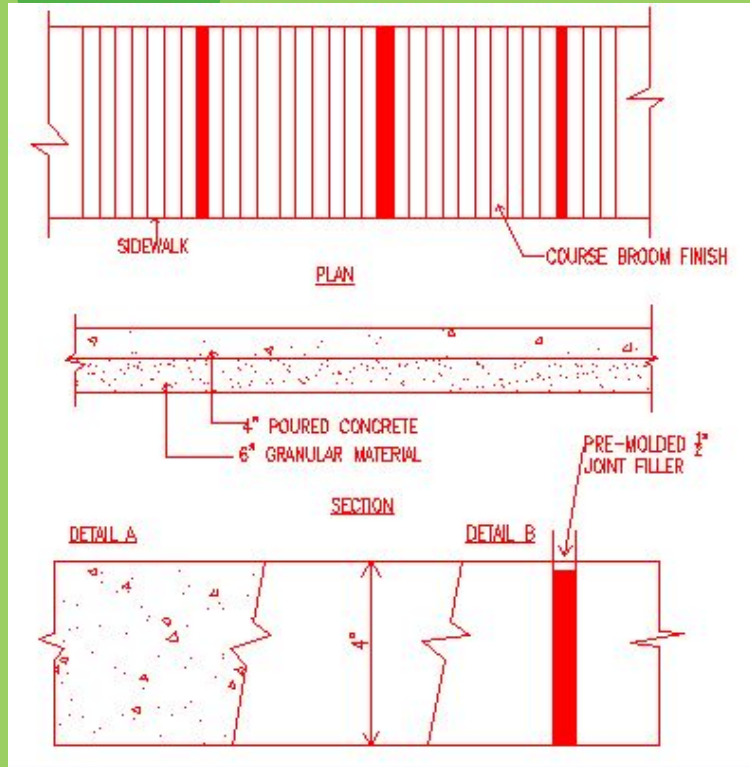

https://www.google.com/search?q=what+is+concrete+sidewalk&client=firefox-b-1-d&sxsrf=ACYBGNT2FyBWoK9nx7HrJ6oTzGn4wXdfvQ:1571440470408&source=Inms&tbm=isch&sa=X&ved=0ahUKEwiiuJj496bIAhVLpFkKHeBDBMEQ_AUIEigC&biw=1525&bih=730#imgrc=4SZ0Lsgn4py-sM:

Silt Fence

A silt fence is a sediment barrier made of porous fabric. The fence is held up by metal or wooden posts that are built into the ground. The fabric holds off stormwater runoff, so the sediments are retained

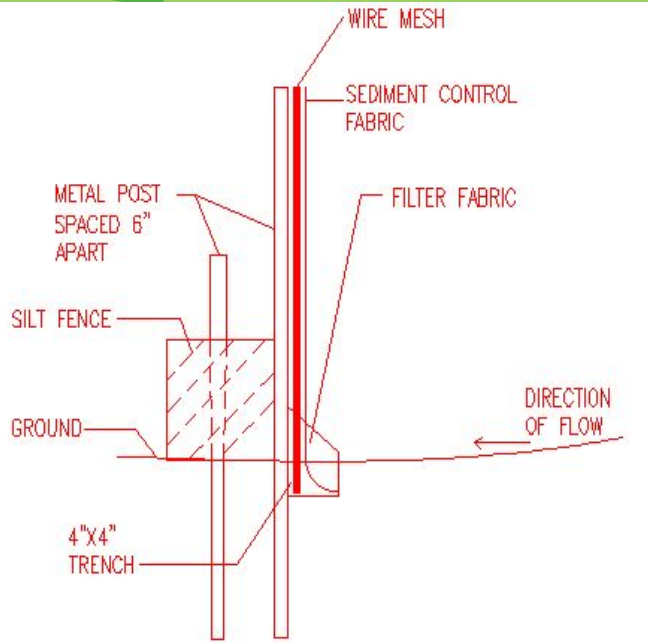

https://www.google.com/search?q=what+is+a+silt+fence&client=firefox-b-1-d&sxsrf=A_CYBGNQJBKr7ZI21hVmLQIZiZDNRWd0IJA:1571440910952&source=Inms&tbm=isch&sa=X&ved=0ahUKEwjaj6HK-abIAhVH11kKHaPcDCwQ_AUIEigC&biw=1525&bih=730#imgrc=f-bCWKWfXclE6M:

Vegetated Swale

A vegetated swale (or bioswale) is a shallow channel that has a variety of grasses, shrubs and trees to slow down and infiltrate stormwater runoff

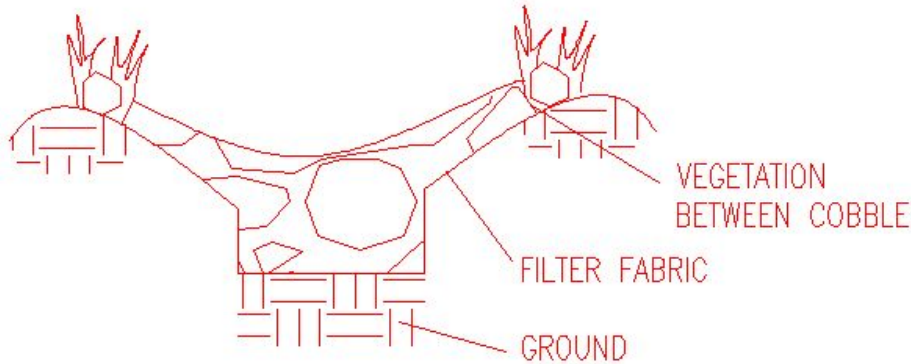

https://www.google.com/search?q=what+is+a+vegetated+swale&client=firefox-b-1-d&sxsrf=ACYBGNSCPya5q350zIt7aXcu7nqicptEPQ:1571441817622&source=lnms&tbm=isch&sa=X&ved=0ahUKewii8Mv6_KblAhVjhOAKHbPcCnYQ_AUIESgB&biw=1525&bih=730#imgrc=7WJzSwinqAs_hM:

Thanks!

ANY QUESTIONS?

